

**Vivienne Geary
Head of Law and Governance**

North Tyneside Council
Quadrant
The Silverlink North
Cobalt Business Park
North Tyneside
NE27 0BY

This matter is being dealt with by:

Ms E A Kerr

Direct Line: (0191) 643 5322

Fax: (0191) 643 2430

email: elizabeth.kerr@northtyneside.gov.uk

Your Ref: 13/01021/TPO

8 August 2013

Mr Derek Muir
St. Mary's Church
Churchill Street
Wallsend
NE28 7TE

Dear Mr Muir

**The Metropolitan Borough of North Tyneside (St. Mary's Church and Vicarage,
Willington, Wallsend) Tree Preservation Order 1981**

With reference to your application to undertake work to trees contained in the above-mentioned Orders, I now enclose the Council's formal notice of its decision.

Yours sincerely

Elizabeth Kerr
Democratic Services Officer
on behalf of Vivienne Geary
Head of Law and Governance

Copy to:

FAO Mr Stuart Murray, Gosforth Tree Surgeons, 44 Rothbury Avenue, Regents Farm Estate, Gosforth, Newcastle upon Tyne, NE3 3HJ

Council of the Borough of North Tyneside

Consent Notice

To: Mr Derek Muir
St. Mary's Church
Churchill Street
Wallsend
NE28 7TE

Planning Ref. No: 13/01021/TPO

The Metropolitan Borough of North Tyneside (St. Mary's Church and Vicarage, Willington, Wallsend) Tree Preservation Order 1981

In accordance with the powers conferred on them by the provisions of the Metropolitan Borough of North Tyneside (St. Mary's Church and Vicarage, Willington, Wallsend) Tree Preservation Order 1981, the Council of the Borough of North Tyneside, as Local Planning Authority, hereby consents to work being carried out to the following trees, subject to the conditions detailed below.

Reference Description and Location of Tree	Description of Works
The following tree is measured from the easternmost corner of the church 24.8m in a south-westerly direction.	(The works hereby permitted may only be carried out once unless the number of occasions is specified in the conditions)
T14 (Sycamore)	- Fell and remove

Condition(s)

1. The works to the tree hereby permitted shall be begun before the expiration of two years from the date of this consent.
Reason: To retain control over the work in the interests of local amenity.
2. Any works hereby permitted shall be undertaken in accordance with BS3998: 2010 Recommendations for Tree Work.
Reason: In order to safeguard existing trees, the amenity of the site and locality, and in the interests of good tree management.
3. The tree to be felled shall be replaced with a sapling Sycamore Tree and located in a position to be agreed in writing with the Local Planning Authority within three months of the date of this decision. The replacement tree shall be planted within the first available planting season following removal of the tree subject to this consent.
Reason: To ensure that the treescape value of the area is retained in the interests of visual amenity.
4. If within a period of 2 years from the date of the planting of the replacement tree, or any further tree planted in replacement, is removed, uprooted,

destroyed, dies or becomes, in the opinion of the Local Planning Authority seriously damaged or defective, another tree of the same species and as that originally planted, pursuant to condition 3; shall be planted at the same place, unless the local planning authority gives its written consent to any variation.
Reason: In the interests of amenity and to ensure a satisfactory standard of tree replacement.

5. The replacement tree shall be planted in accordance with BS4428:1989 'Code of practise for general landscape operations (excluding hard surfaces)', BS4043:1989 'Transplanting root balled trees' and BS:3936:1992 Part 1 of Part 4: 'Nursery Stock- Specification for trees and shrubs'.
Reason: To protect and preserve natural amenity and in the interest of good tree management.

Your Right to Appeal

You have the right to appeal against the Council's decision to the Department for Communities and Local Government. If you wish to pursue this course of action you will need to do so in writing, within 28 days of receiving this notice, to:

The Environment Team
The Planning Inspectorate
Room 4/04, Kite Wing
Temple Quay House
2 The Square
Temple Quay
BRISTOL
BS1 6PN.

If you suffer any loss or damage which is caused or incurred in consequence of this granting of consent subject to conditions, you may be entitled to recover from the Council compensation in respect of such loss or damage.

No claim can be made if more than 12 months has elapsed from the date of this decision (or, if you appeal to the Department for Communities and Local Government, within 12 months from the date of their decision) or if the claim would be for less than £500. Claims should be submitted in writing to this office.

Dated this 8th day of August 2013



Vivienne Geary
Head of Law and Governance
North Tyneside Council
Quadrant
The Silverlink North
Cobalt Business Park
North Tyneside
NE27 0BY

TREE PRESERVATION ORDER : ST. MARY'S CHURCH AND VICARAGE,
WILKINGTON

FIRST SCHEDULE

The map referred to is to a scale of 1:500 and is based on an enlargement of the 1:1250 C.S. sheet numbered NZ 3167 NE.

The area covered is the church grounds to the east of Churchill Street and south of Perth Gardens, and the old vicarage grounds to the west of Churchill Street and south of Engine Inn Road.

The area is wholly within the boundaries of the Metropolitan Borough of North Tyneside.

TREES SPECIFIED INDIVIDUALLY
(Encircled in black on the plan)

No. on plan	Description	Situation
		<p>The following trees are measured from the lower north-west corner of the church.</p> <p>In a north-westerly direction.</p>
F1 F2	Elm Sycamore	10.6m 16m
F3	Sycamore Sycamore	<p>In a northerly direction.</p> <p>25m 24.4m</p>
F5	Elm	22.5m
F6 F7 F8	Elm Sycamore Elm	<p>The following trees are measured in an easterly direction from the northernmost corner of the church.</p> <p>17.3m 23.2m 23.0m</p>
F9 F10	Sycamore Sycamore	<p>The following trees are measured from the easternmost corner of the church.</p> <p>In a south-easterly direction.</p> <p>8.5m 12.8m</p>

Description

Situation

		In a southerly direction
T11	Sycamore	10.5m
T12	Sycamore	13.6m
		In a south-westerly direction.
T13	Sycamore	18.7m
T14	Sycamore	24.8m
T15	Elm	28.3m
T16	Elm	29.9m
T17	Elm	35.5m
		The following tree is measured in a southerly direction from the south-eastern corner of the vicarage.
T18	Beech	18.6m
		The following trees are measured from the southernmost corner of the vicarage.
		In a southerly direction.
T19	Chestnut	17.5m
		In a south-westerly direction.
T20	Elm	9m
		In a westerly direction.
T21	Sycamore	6.5m
T22	Sycamore	10m

GROUPS OF TREES(Within a broken line on the plan)

G1	Group consisting of 2 elms and 7 sycamores.	Situated to the south of the south-eastern corner of the vicarage, extending for 18.5m to the south-east and 11m to the east.
----	---	---

TREES SPECIFIED WITH REFERENCE TO AN AREA

NONE

WOODLAND

NONE

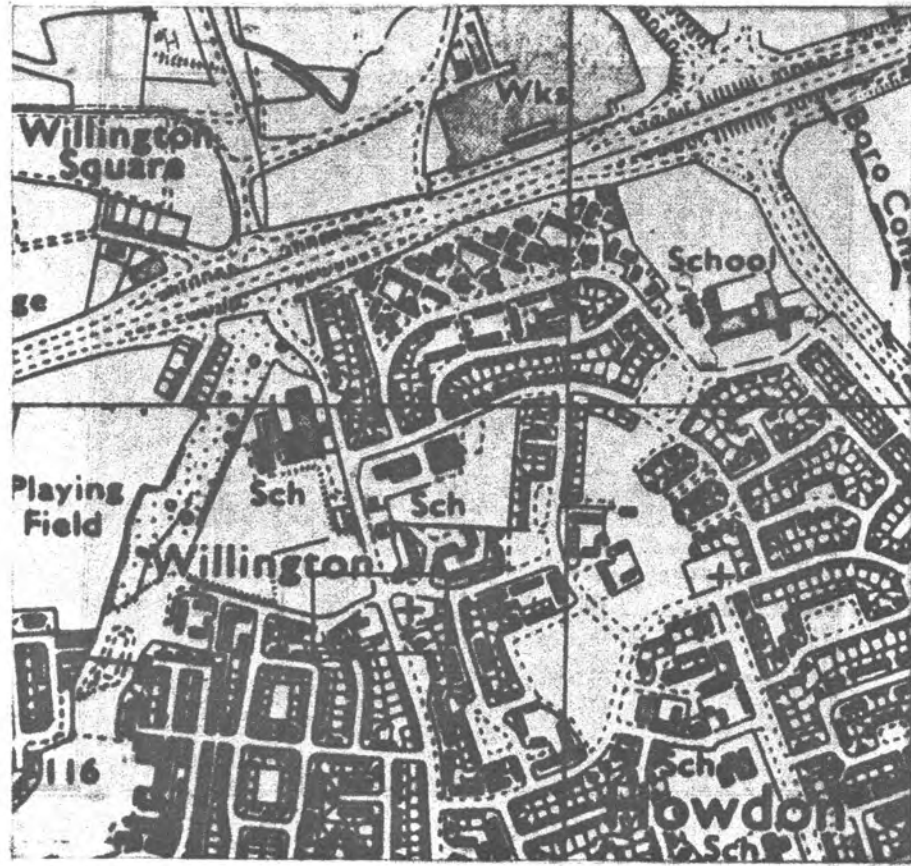

LOCATION PLAN

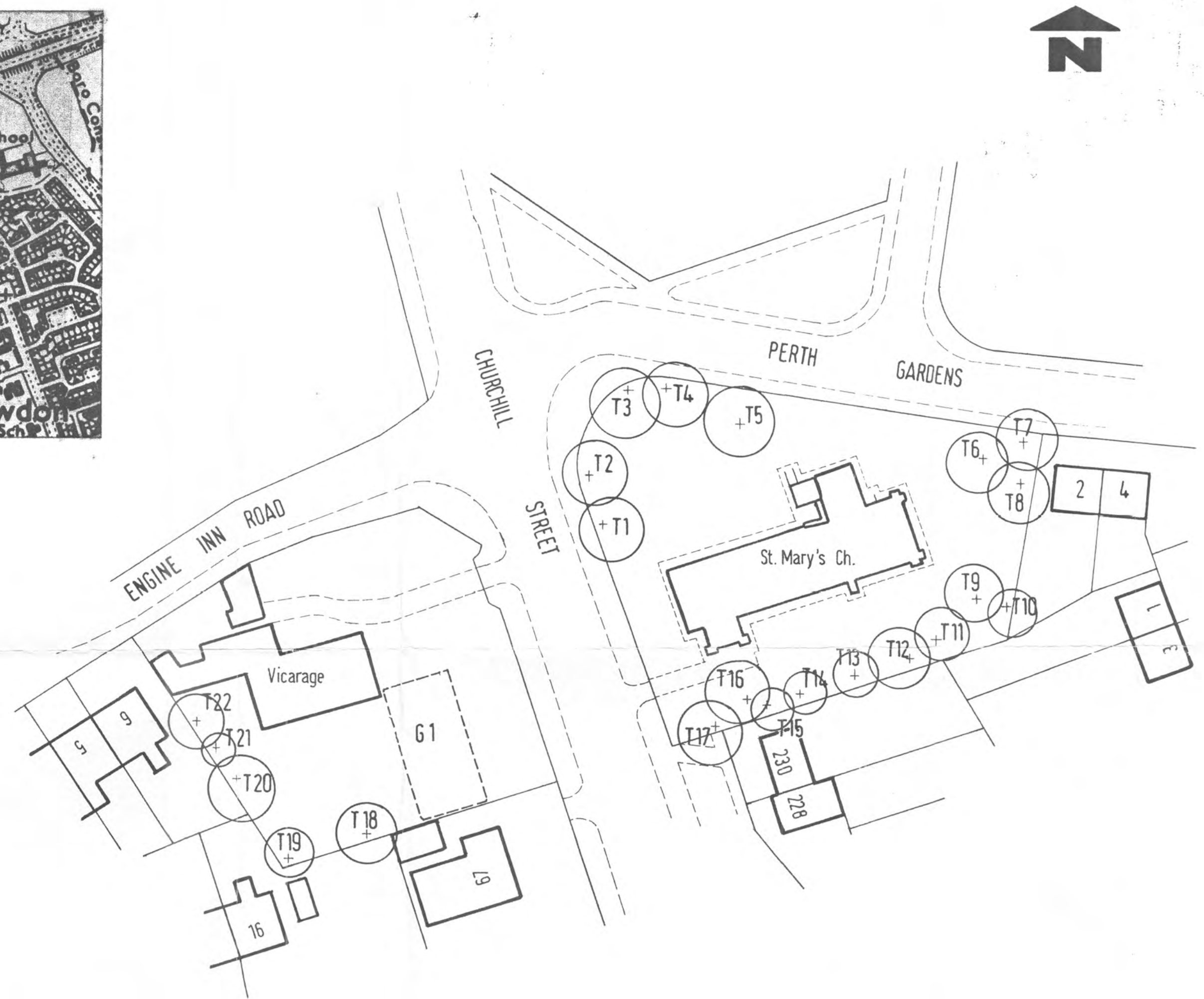

METROPOLITAN BOROUGH OF NORTH TYNESIDE
 St. Mary's Church and Vicarage, Willington.
 TREE PRESERVATION ORDER 1981

SCALE 1:500

DRG. No. TPO/A2/1380-6

A. HOLDSWORTH C.Eng. M.R.T.P.I. M.I.C.E. M.I.Mun.E. CHIEF PLANNING OFFICER