

FIRST SCHEDULE

The map referred to is at a scale of 1:1250 and is based on an enlargement of the 1:25,000 O.S. Northumberland Edition of 1960, sheet numbers 3272/3172. The area covered by the order is to the North of Manor House Cottages, Church Way, Earsdon Village.

The area is wholly within the Metropolitan Borough of North Tyneside in the County of Tyne and Wear.

TREES SPECIFIED INDIVIDUALLY
(Encircled in black on the map)

No. on the Map	Description	Situation
T 1	Sycamore	Situated 1.5 m in a northerly direction from the north boundary wall of Manor House Cottages and 0.5 m in a westerly direction from the stone boundary wall.

GROUPS OF TREES

NONE

TREES SPECIFIED WITH REFERENCE TO AN AREA

NONE

WOODLAND

NONE

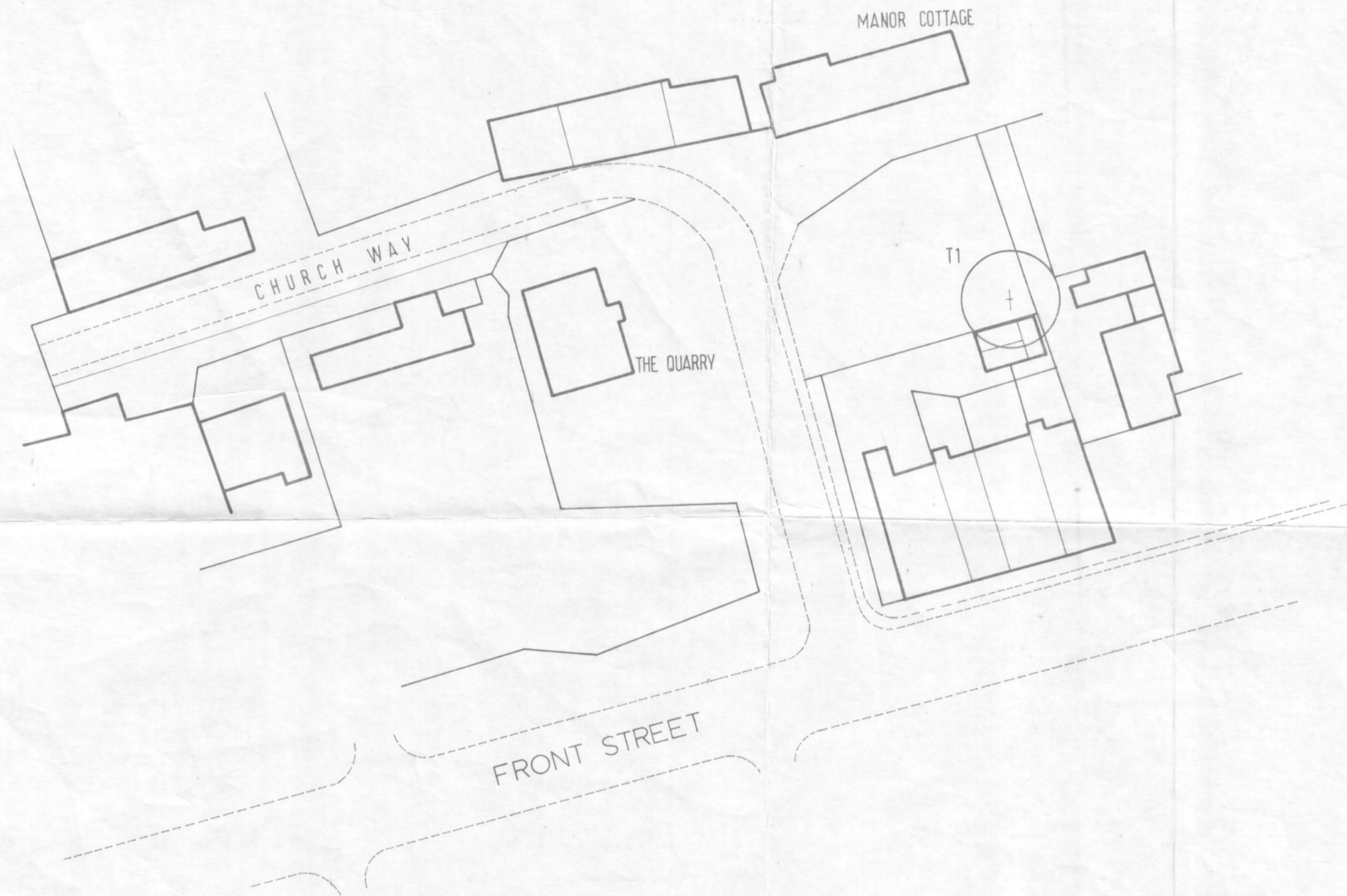

METROPOLITAN BOROUGH OF NORTH TYNESIDE

CHURCH WAY EARSDON

TREE PRESERVATION ORDER 1976

SCALE 1:500

DRAWING TPO/DSV/A2/1378-3

A.HOLDSWORTH C.Eng.M.R.T.P.I.,M.I.C.E.,M.I.,Mun.E. CHIEF PLANNING OFFICER.