

TOWN AND COUNTRY PLANNING ACT, 1971

THE METROPOLITAN BOROUGH OF NORTH TYNESIDE  
(THE BIELD, FOREST HALL)  
TREE PRESERVATION ORDER, 1975

THE COUNCIL of the METROPOLITAN BOROUGH OF NORTH TYNESIDE in exercise of their powers under Section 60(5)(c) of the Town and Country Planning Act, 1971, HEREBY confirm, without modification, the foregoing Order as an unopposed Order.

IN WITNESS whereof the Common Seal of the North Tyneside Borough Council was hereunto affixed this 22<sup>nd</sup> day of March 1976.

  
Mayor

  
Chief Legal Adviser

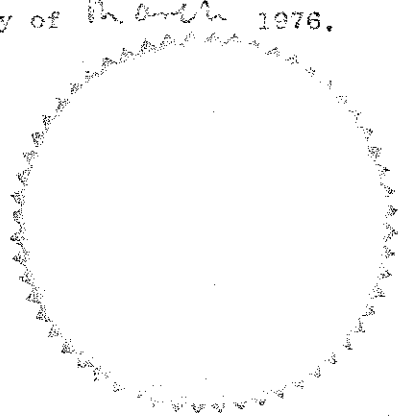

NT/3/75 TMS

FIRST SCHEDULE

The map referred to is at a scale of 1:200 and is an enlargement of the 1:1250 Ordnance Survey Edition of 1963, Sheet No. NZ2770SE and the area covered by the Order is situated in the Forest Hall Area in the Metropolitan Borough of North Tyneside in the County of Tyne and Wear.

TREES SPECIFIED INDIVIDUALLY

No. on The Map	Description	Situation
T1	Sycamore	Approximately 10 metres south west of the south western corner of No. 8 Elm Grove.
T2	Laburnum	Approximately 8.5 metres north west of the south western corner of No. 8 Elm Grove.
<del>T3</del>	<del>Rowan</del>	<del>Approximately 5 metres south west of the north western corner of No. 12 Elm Grove. REMOVED SEPTEMBER 1977</del>
<p>The following trees are all situated along the eastern boundary of the grounds of The Bield and are measured from the north east corner of the site, adjoining No. 1 Elm Grove.</p>		
T4	Sycamore	Approximately 57 metres in a southerly direction.
T5	Rowan	Approximately 52 metres in a southerly direction.
T6	Elm	Approximately 44 metres in a southerly direction.
T7	Sycamore	Approximately 38.5 metres in a southerly direction.
T8	Sycamore	Approximately 32 metres in a southerly direction.
T9	Sycamore	Approximately 28 metres in a southerly direction.
T18	Sycamore	Approximately 4.5 metres in a southerly direction.
<p>The following trees are all situated near to the western boundary of the grounds of The Bield and are measured from the north west corner of the site, adjoining No. 1 Elm Grove and No. 12 Leybourne Avenue.</p>		
T10	Ash	Approximately 31 metres in a southerly direction.
T11	Sycamore	Approximately 28.5 metres in a southerly direction.
T12	Ash	Approximately 20.5 metres in a southerly direction.

No. on The Map	Description	Situation
T13 T14 T15 T16 T17	Sycamore Sycamore Sycamore Sycamore Sycamore	Approximately 13.5 metres in a southerly direction. Approximately 5 metres in a southerly direction. Approximately 4 metres in a southerly direction. Approximately 0.5 metres in a southerly direction. Approximately 0.8 metres in a southerly direction.
		<p><u>GROUPS OF TREES</u> (Within a broken black line on the map)</p>
No. on The Map	Description	Situation
G1	2 No. Ash 3 No. Cherry 1 No. Swedish Whitebeam 1 No. Elm 1 No. Horse-Chesnut 1 No. Lombardy Poplar 1 No. Birch 18 No. Sycamore 1 No. Rowan	At the southern end of the grounds of The Bield, at the junction of Elm Grove and Leybourne Avenue, and standing within The Bield and No. 2 Leybourne Avenue.
		There are no other classifications of trees included in this Order.



Location plan

The Field TPO, Elm Grove, Forest Hall, 1975

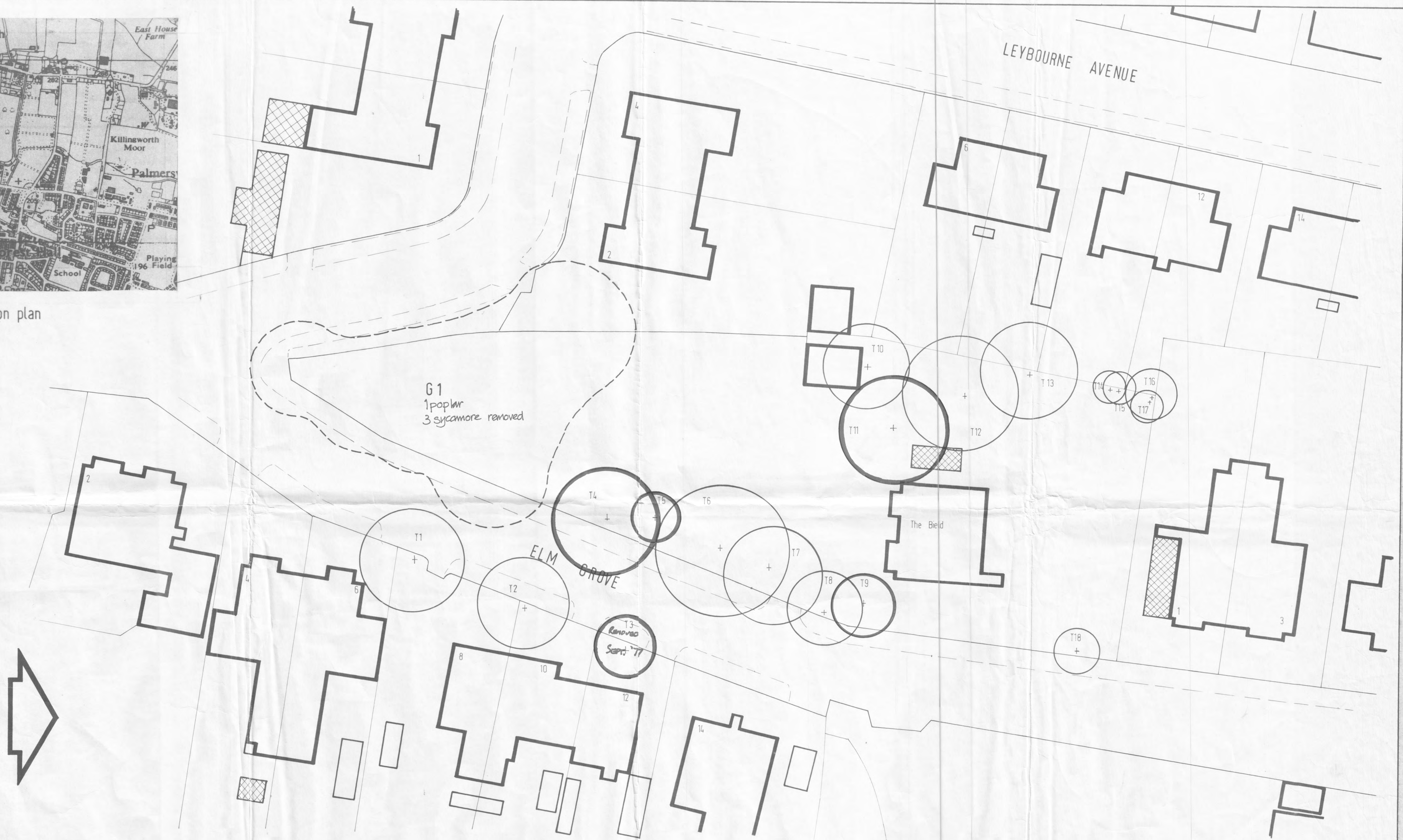

METROPOLITAN BOROUGH OF NORTH TYNESIDE

(THE BIELD, FOREST HALL)

TREE PRESERVATION ORDER 1975

SCALE 1:200



DRAWING No. TPO/DSL/A1/1377-14

A. HOLDSWORTH C. Eng, M.R.T.P.I., M.I.C.E., M.I.Mun.E. CHIEF PLANNING OFFICER.