

COUNTY OF NORTHUMBERLAND

THE COUNTY OF NORTHUMBERLAND (BENTON COTTAGE,

LONGBENTON) TREE PRESERVATION ORDER, 1969

TO: D. Cowgill, Esq.,
10 Parkland,
Newcastle upon Tyne,
NE12 3LL

In accordance with the provisions of the County of Northumber-
land (Benton Cottage, Longbenton) Tree Preservation Order, 1969,
the County Council of the Administrative County of Northumberland,
as Local Planning Authority, HEREBY CONSENT to the felling of the
undermentioned tree:-

<u>Ref. No.</u>	<u>Description of Tree</u>
G.1	One Sycamore tree situated in the group of trees marked G.1 on the map and described in the first Schedule to the above-mentioned Order which has been previously agreed with the County Planning Officer.

Dated this 3rd day of August, 1972.

(Sd) C.W. HUGLER.

Clerk of the County Council

County Hall,
Newcastle upon Tyne,
NE1 1SA

Trees specified individually
(Encircled in black on the map)

No. on the Map	Description	Situation
T.1	Sycamore	Approximately 82 feet in a south easterly direction from the north western corner of the grounds of Benton Cottage and 91 feet in a north easterly direction from the south western corner of the said grounds.
T.2	Sycamore	Approximately 87 feet in a south westerly direction from the north eastern corner of the said grounds and 75 feet in a north westerly direction from the south eastern corner of the said grounds. The following trees measured in a southe direction along the eastern boundary from the north eastern corner of the said grounds.
T.3	Sycamore	Approximately 110 feet south of the said corner and offset 3 feet to the west.
T.4	Sycamore	Approximately 130 feet south of the said corner and offset 3 feet to the west.
T.5	Elm	Approximately 139 feet south of the said corner and offset 4 feet to the west. The following trees measured in a wester direction along the southern boundary from the south eastern corner of the said grounds.
T.6	Sycamore	Approximately 68 feet west of the said corner and offset 4 feet to the north.
T.7	Sycamore	Approximately 78 feet west of the said corner and offset 3 feet to the north.

Areas

N O N E

Woodlands

N O N E

Groups of Trees

(Within a broken black line on the map)

No. on the Map	Description	Situation
G.1	Group consisting of 5 Elm, 4 ³ Sycamore and 1 Horse Chestnut.	Lying approximately 86 feet in a north westerly direction from the south eastern corner of the said grounds and extending to the northern boundary.

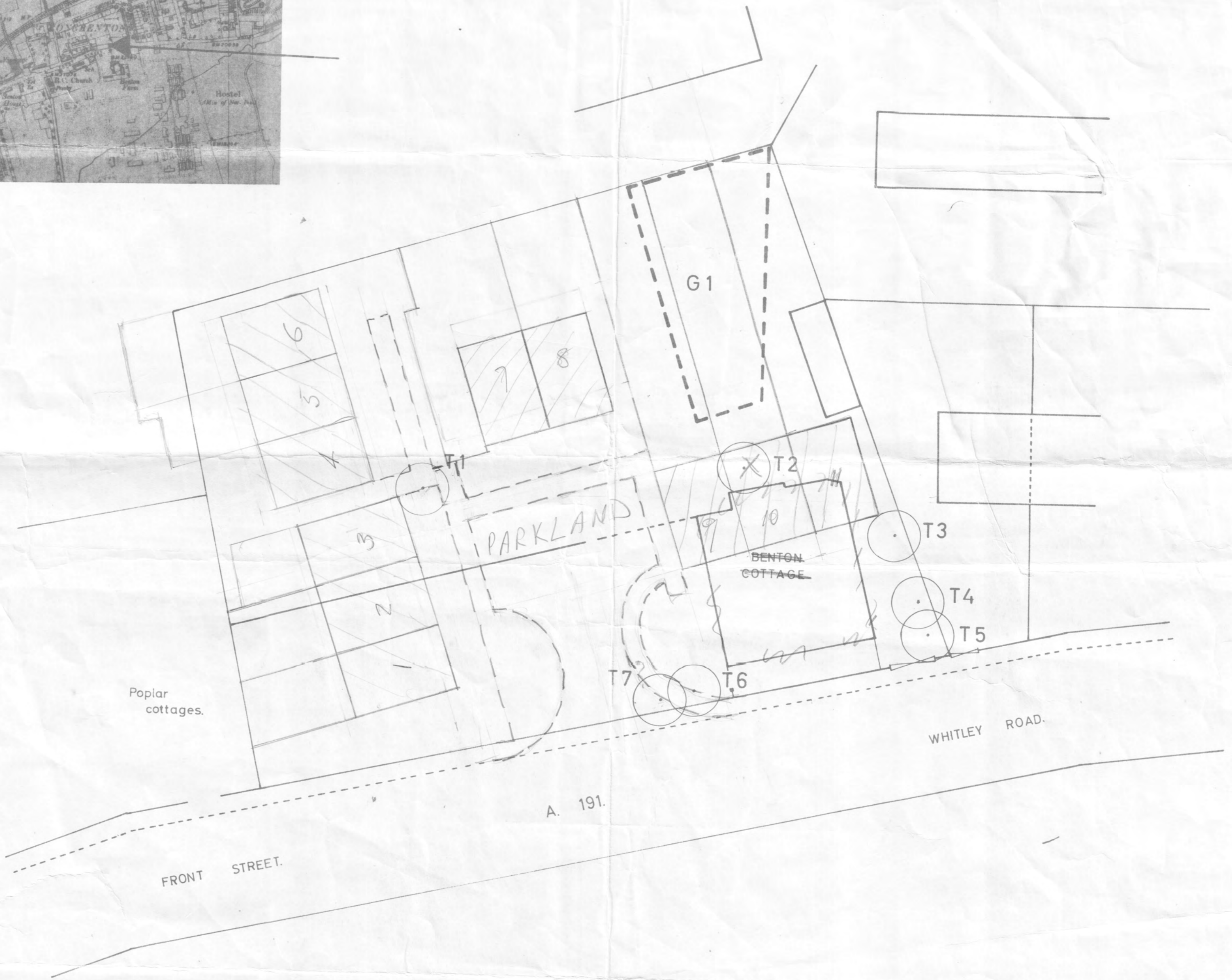

Scale 1 = 250.

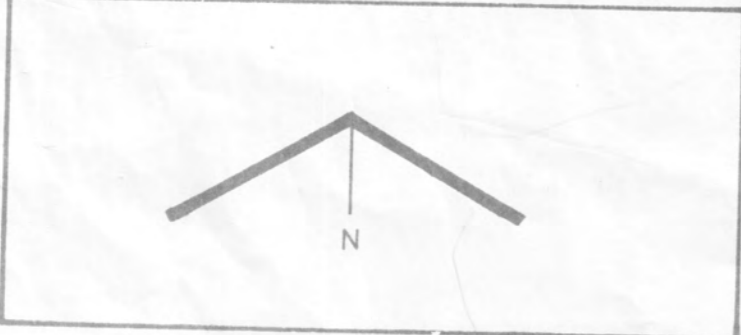

THE COUNTY OF NORTHUMBERLAND.
(BENTON COTTAGE, LONGBENTON).
TREE PRESERVATION ORDER. 1967.

J. B. ROSS. F. R. I. C. S.
County Planning Officer.
Drawing No. La/TPO/687
JANUARY 1967