



**North Tyneside
Council**

**Town and Country Planning Act 1990
The Council of the Borough of North Tyneside (Castle Farm House,
Backworth) Tree Preservation Order (2025)**

CONFIRMATION OF ORDER

This Order was confirmed by the Council of the Borough of North Tyneside without modification on the 19th day of February 2025.

The Common Seal of the Council of the Borough of North Tyneside was affixed to this order in the presence of:

Authorised Signatory



Town and Country Planning Act 1990
The Council of the Borough of North Tyneside (Castle Farm House,
Backworth) Tree Preservation Order 2025

The Council of the Borough of North Tyneside in exercise of the powers conferred on them by sections 198 of the Town and Country Planning Act 1990 hereby make the following Order—

Citation

1. This Order may be cited as the (Castle Farm House, Backworth) Tree Preservation Order 2025.

Interpretation

2. (1) In this Order “the authority” means the Council of the Borough of North Tyneside

(2) In this Order any reference to a numbered section is a reference to the section so numbered in the Town and Country Planning Act 1990 and any reference to a numbered regulation is a reference to the regulation so numbered in the Town and Country Planning (Tree Preservation)(England) Regulations 2012.

Effect

3.—(1) Subject to article 4, this Order takes effect provisionally on the date on which it is made.

(2) Without prejudice to subsection (7) of section 198 (power to make tree preservation orders) or subsection (1) of section 200 (tree preservation orders: Forestry Commissioners) and, subject to the exceptions in regulation 14, no person shall—

(a) cut down, top, lop, uproot, wilfully damage, or wilfully destroy; or

(b) cause or permit the cutting down, topping, lopping, wilful damage or wilful destruction of,

any tree specified in the Schedule to this Order except with the written consent of the authority in accordance with regulations 16 and 17, or of the Secretary of State in accordance with regulation 23, and, where such

consent is given subject to conditions, in accordance with those conditions.

Application to trees to be planted pursuant to a condition

4.—In relation to any tree identified in the first column of the Schedule by the letter "C", being a tree to be planted pursuant to a condition imposed under paragraph (a) of section 197 (planning permission to include appropriate provision for preservation and planting of trees), this Order takes effect as from the time when the tree is planted.

Dated this 15th day of January 2025

The Common Seal of the
Council of the Borough of North Tyneside
was affixed to this order in the presence of:

Authorised Signatory



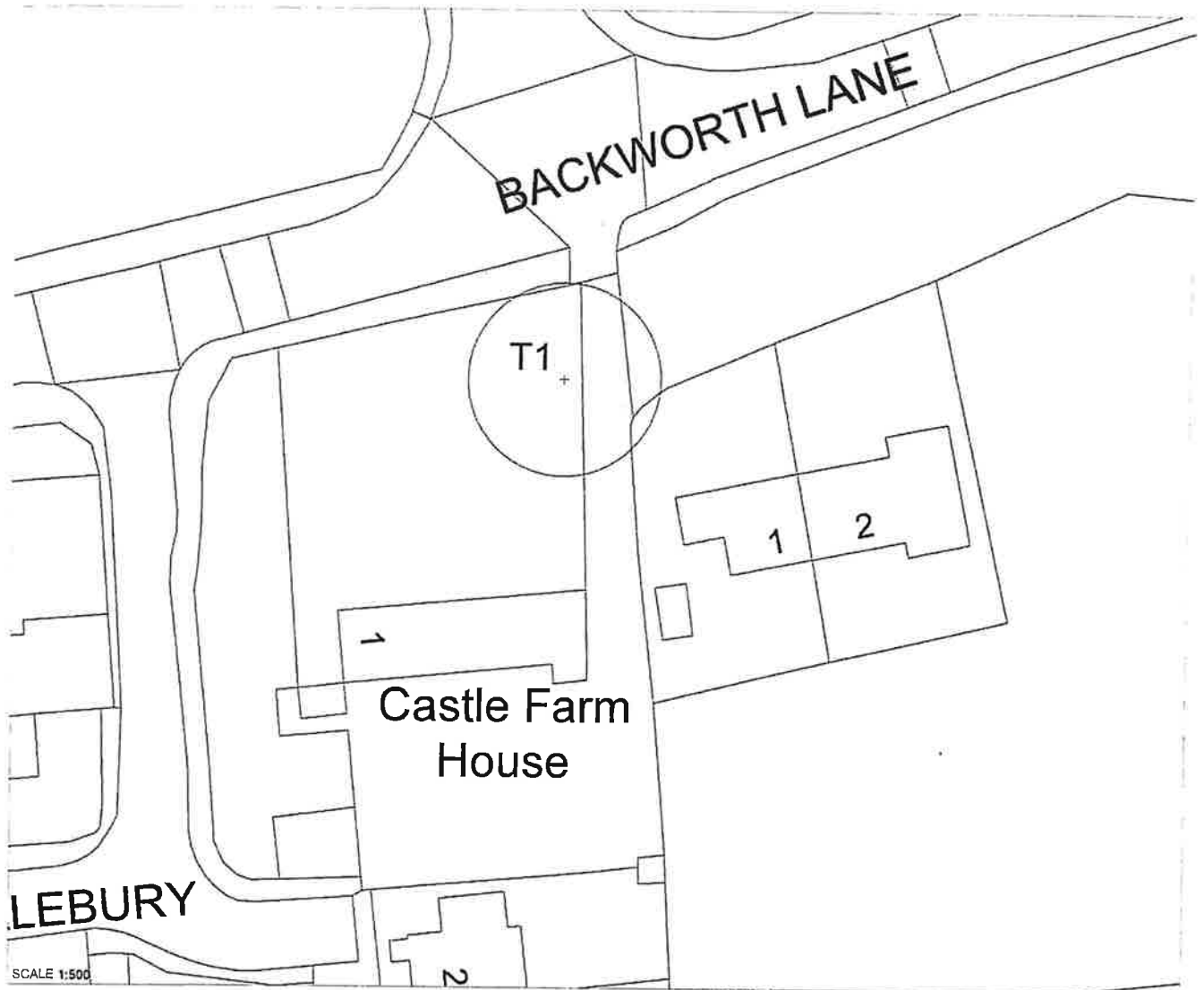

SCALE 1:500

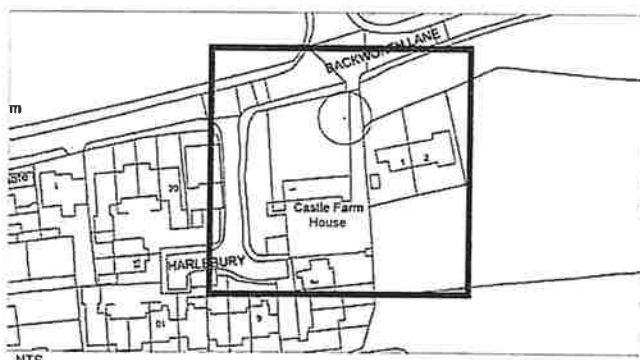

JOHN SPARKES
DIRECTOR OF REGENERATION AND ECONOMIC
DEVELOPMENT

QUADRANT EAST
THE SILVERLINK
COBALT BUSINESS PARK
NORTH TYNESIDE
NE27 0BY

© Crown Copyright and database 2024.
Ordnance Survey Licence Number AC9000820329



157297

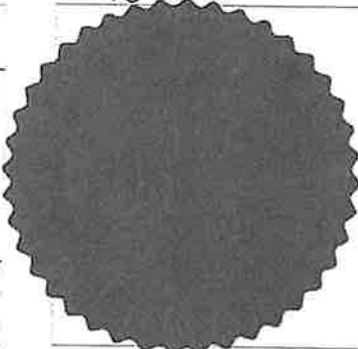

Dated this day :
15 Jan 2025 (date)

The Common Seal of the Council of
the Borough of North Tyneside was
affixed to this Order in the presence of :

Stephen G. Ballantyne
(Authorised Signatory)

NORTH TYNESIDE COUNCIL
TREE PRESERVATION ORDER 2025

CASTLE FARM HOUSE
BACKWORTH

TREE PRESERVATION ORDER 2024

CASTLE FARM HOUSE, BACKWORTH LANE

SCHEDULE

The map referred to is at a scale of 1:500 and is based on an enlargement of an O.S. base plan. The area covered by the Order is on land adjacent to Backworth Lane, Backworth, NE27 OAU. The area is wholly within the Metropolitan Borough of North Tyneside in the County of Tyne and Wear.

SPECIFICATION OF TREES

TREES SPECIFIED INDIVIDUALLY (encircled in black on the map)		
<i>Reference on map</i>	<i>Description</i>	<i>Situation</i>
T1	Poplar (<i>Populus</i> sp.)	Located approximately 20m south of the centre of the road junction of Fisher Rd and Backworth Lane in the grounds of the garden of Castle Farm House.

TREES SPECIFIED BY REFERENCE TO AN AREA (within a dotted black line on the map)		
<i>Reference on map</i>	<i>Description</i>	<i>Situation</i>
None		

GROUPS OF TREES (within a broken black line on the map)		
<i>Reference on map</i>	<i>Description</i>	<i>Situation</i>
None		

WOODLANDS (within a continuous black line on the map)		
<i>Reference on map</i>	<i>Description</i>	<i>Situation</i>
None		