

Town and Country Planning Act 1990
The Council of the Borough of North Tyneside (Land to the rear of Meadow Drive, Seaton Burn, Tyne and Wear) Tree Preservation Order 2013

The Council of the Borough of North Tyneside in exercise of the powers conferred on them by sections 198 of the Town and Country Planning Act 1990 hereby make the following Order—

Citation

1. This Order may be cited as the Council of the Borough of North Tyneside (Land to the rear of Meadow Drive, Seaton Burn, Tyne and Wear) Tree Preservation Order 2013

Interpretation

2. (1) In this Order “the authority” means the Council of the Borough of North Tyneside

(2) In this Order any reference to a numbered section is a reference to the section so numbered in the Town and Country Planning Act 1990 and any reference to a numbered regulation is a reference to the regulation so numbered in the Town and Country Planning (Tree Preservation)(England) Regulations 2012.

Effect

3.—(1) Subject to article 4, this Order takes effect provisionally on the date on which it is made.

(2) Without prejudice to subsection (7) of section 198 (power to make tree preservation orders) or subsection (1) of section 200 (tree preservation orders: Forestry Commissioners) and, subject to the exceptions in regulation 14, no person shall—

(a) cut down, top, lop, uproot, wilfully damage, or wilfully destroy; or

(b) cause or permit the cutting down, topping, lopping, wilful damage or wilful destruction of,

any tree specified in the Schedule to this Order except with the written consent of the authority in accordance with regulations 16 and 17, or of the Secretary of State in accordance with regulation 23, and, where such consent is given subject to conditions, in accordance with those conditions.

Application to trees to be planted pursuant to a condition

4.—In relation to any tree identified in the first column of the Schedule by the letter “C”, being a tree to be planted pursuant to a condition imposed under paragraph (a) of section 197 (planning permission to include appropriate provision for

preservation and planting of trees), this Order takes effect as from the time when the tree is planted.

Dated this 19th day of December 2013

The Common Seal of the
Council of the Borough of North Tyneside
was affixed to this order in the presence of:

DEPUTY Chair of the Council *M. Lubiana*

Stephen G. Ballantyne
Authorised signatory



Tree Preservation Order 2013
Land to the rear of Meadow Drive, Seaton Burn, Tyne and Wear

Schedule

The map referred to is at a scale of 1:500 and is based on an enlargement of the 1:1250 O.S. edition of sheet numbered NZ 2473. The area covered by the Order is land to the south of Meadow Drive, Seaton Burn, Tyne and Wear.

The area is wholly within the Metropolitan Borough of North Tyneside in the County of Tyne and Wear.

Specification of trees

Trees specified individually
(encircled in black on the map)

The following trees are measured from the western field boundary line junction with the garden fence to rear of 40/42 Meadow Drive, Seaton Burn [Point A]

<i>Reference on map</i>	<i>Description</i>	<i>Situation</i>
T1	Horse Chestnut	Located approximately 25.8 metres South; offset 5.7 metres in an easterly direction.
T2	Oak	Located approximately 22.7 metres South; offset 33.6 metres in an easterly direction.
T3	Oak	Located approximately 13.2 metres South; offset 30.7 metres in an easterly direction.
T4	Oak	Located approximately 7.6 metres South; offset 45.9 metres in an easterly direction.

Trees specified by reference to an area
(within a dotted black line on the map)

<i>Reference on map</i>	<i>Description</i>	<i>Situation</i>
None		

Groups of trees

(within a broken black line on the map)

None

Woodlands

(within a continuous black line on the map)

<i>Reference on map</i>	<i>Description</i>	<i>Situation</i>
-------------------------	--------------------	------------------

None

The common seal of the Council of the Borough of North Tyneside was hereunto affixed this 19th day of December 2013 in the presence of:

Julianne
 Chair of the Council

Stephen G Bellenger
 Authorised Signatory

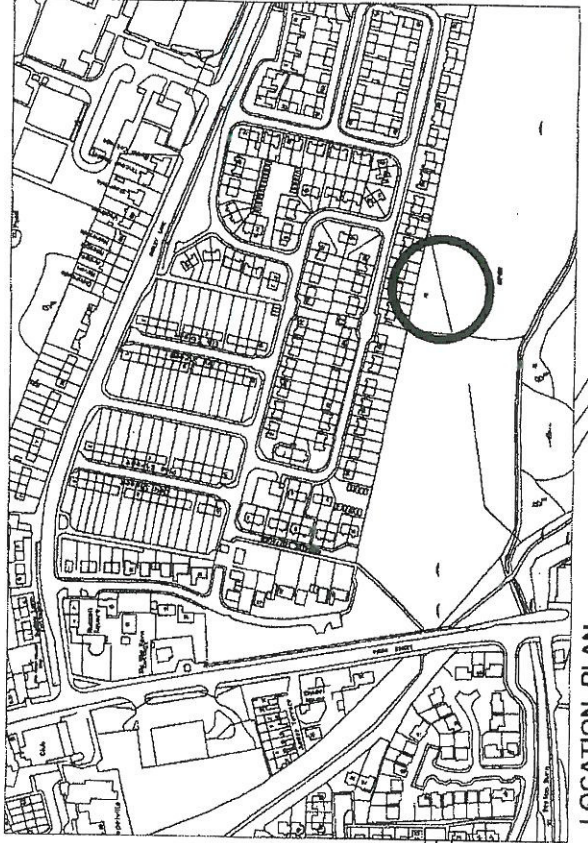
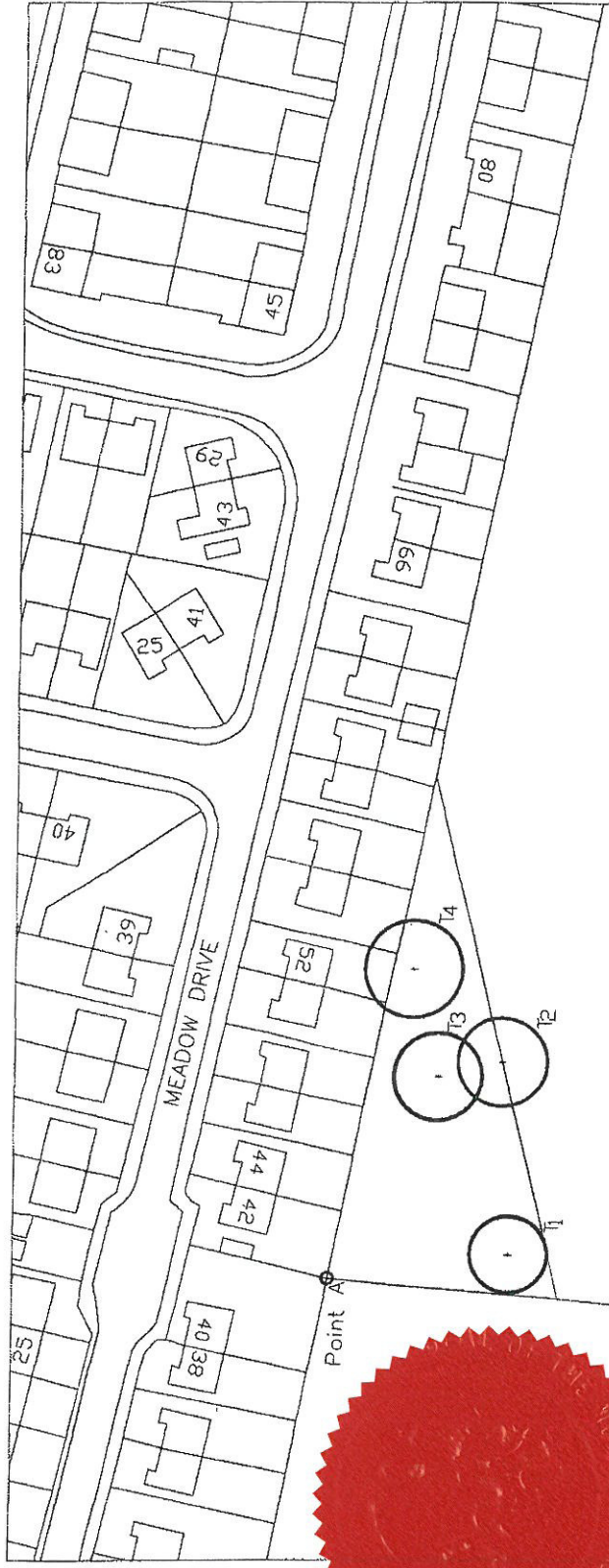
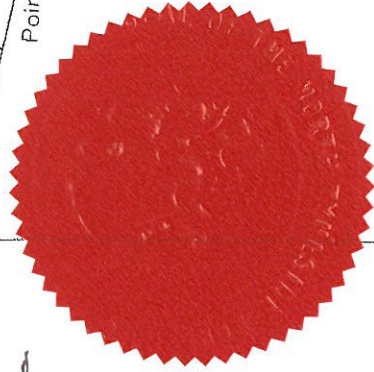

LOCATION PLAN Scale 1:2500

NORTH TYNESIDE COUNCIL
 REAR OF MEADOW DRIVE, SEATON BURN, TYNE AND WEAR
TREE PRESERVATION ORDER 2013

PHL 8027
 Names of Designated and Listed Trees
 The Borough
 Council Reference Data
 Council Reference Data
 NSEP 01/13

Scale 1:500

This map is based on Ordnance Survey aerials with the assistance of Drone Survey carried out by the Council of the Borough of North Tyneside. Unauthorised reproduction (without Crown copyright and permission of the Ordnance Survey) is prohibited.

NORTH

Town and Country Planning Act 1990
**The Council of the Borough of North Tyneside (Land to the rear of Meadow Drive,
Seaton Burn, Tyne and Wear) Tree Preservation Order 2013**

CONFIRMATION OF ORDER

This Order was confirmed by the Council of the Borough of North Tyneside without modification on the 6th day of February 2014.

The Common Seal of the Council of the Borough of North Tyneside was affixed to this Order in the presence of:

Janet Hurve

Chair of the Council

Stephen G. Bellamy

Authorised Signatory

