

Town and Country Planning Act 1990
The Council of the Borough of North Tyneside (Allotment Gardens south west of 5 Northumberland Terrace, Tynemouth) Tree Preservation Order 2012

The Council of the Borough of North Tyneside in exercise of the powers conferred on them by sections 198 of the Town and Country Planning Act 1990 hereby make the following Order—

Citation

1. This Order may be cited as the (Allotment Gardens south west of Northumberland Terrace, Tynemouth) Tree Preservation Order 2012.

Interpretation

2. (1) In this Order “the authority” means the Council of the Borough of North Tyneside

(2) In this Order any reference to a numbered section is a reference to the section so numbered in the Town and Country Planning Act 1990 and any reference to a numbered regulation is a reference to the regulation so numbered in the Town and Country Planning (Tree Preservation)(England) Regulations 2012.

Effect

3.—(1) Subject to article 4, this Order takes effect provisionally on the date on which it is made.

(2) Without prejudice to subsection (7) of section 198 (power to make tree preservation orders) or subsection (1) of section 200 (tree preservation orders: Forestry Commissioners) and, subject to the exceptions in regulation 14, no person shall—

(a) cut down, top, lop, uproot, wilfully damage, or wilfully destroy; or

(b) cause or permit the cutting down, topping, lopping, wilful damage or wilful destruction of,

any tree specified in the Schedule to this Order except with the written consent of the authority in accordance with regulations 16 and 17, or of the Secretary of State in accordance with regulation 23, and, where such consent is given subject to conditions, in accordance with those conditions.

Application to trees to be planted pursuant to a condition

4.—In relation to any tree identified in the first column of the Schedule by the letter “C”, being a tree to be planted pursuant to a condition imposed under paragraph (a) of section 197 (planning permission to include appropriate provision for preservation and planting of trees), this Order takes effect as from the time when the tree is planted.

Dated this 26 day of November 2012

The Common Seal of the
Council of the Borough of North Tyneside
was affixed to this order in the presence of:

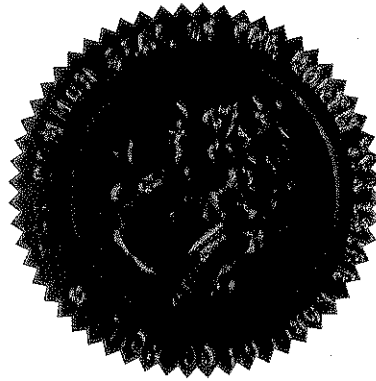

A handwritten signature in black ink, appearing to read 'J. Scott', written in a cursive style.

Chair of the Council

A handwritten signature in black ink, appearing to read 'J. [unclear]', written in a cursive style.

Head of Legal, Governance and
Commercial Services

TREE PRESERVATION ORDER 2012
ALLOTMENT GARDENS SOUTH WEST OF 5 NORTHUMBERLAND TERRACE,
TYNEMOUTH

SCHEDULE

The map referred to is at a scale of 1:500 and is based on an enlargement of the 1:1250 O.S. edition of sheet numbered NZ 3669. The area covered by the Order is allotment garden south west of 5 Northumberland Terrace, Tynemouth, Tyne and Wear.

The area is wholly within the Metropolitan Borough of North Tyneside.

Specification of trees

Trees specified individually
(encircled in black on the map)

<i>Reference on map</i>	<i>Description</i>	<i>Situation</i>
T1	Ash (<i>Fraxinus</i> sp)	Located approximately 13.1m in a north westerly direction from the south east corner of the land used as a garden. (marked * on the plan)

Trees specified by reference to an area
(within a dotted black line on the map)

<i>Reference on map</i>	<i>Description</i>	<i>Situation</i>
None		

Groups of trees
(within a broken black line on the map)

None		
------	--	--

Woodlands
(within a continuous black line on the map)

<i>Reference on map</i>	<i>Description</i>	<i>Situation</i>
None		

Dated this 26 day of November 2012

The Common Seal of the Council of the Borough of North Tyneside was affixed to this order in the presence of:

Chair of the Council
Head of Legal, Governance and Commercial Services

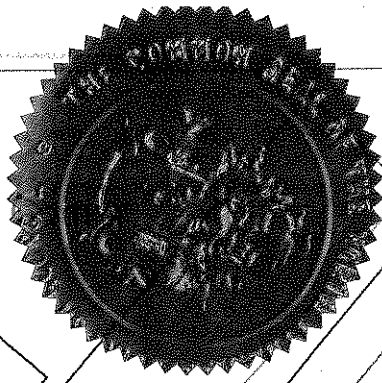

South
[Handwritten signature]

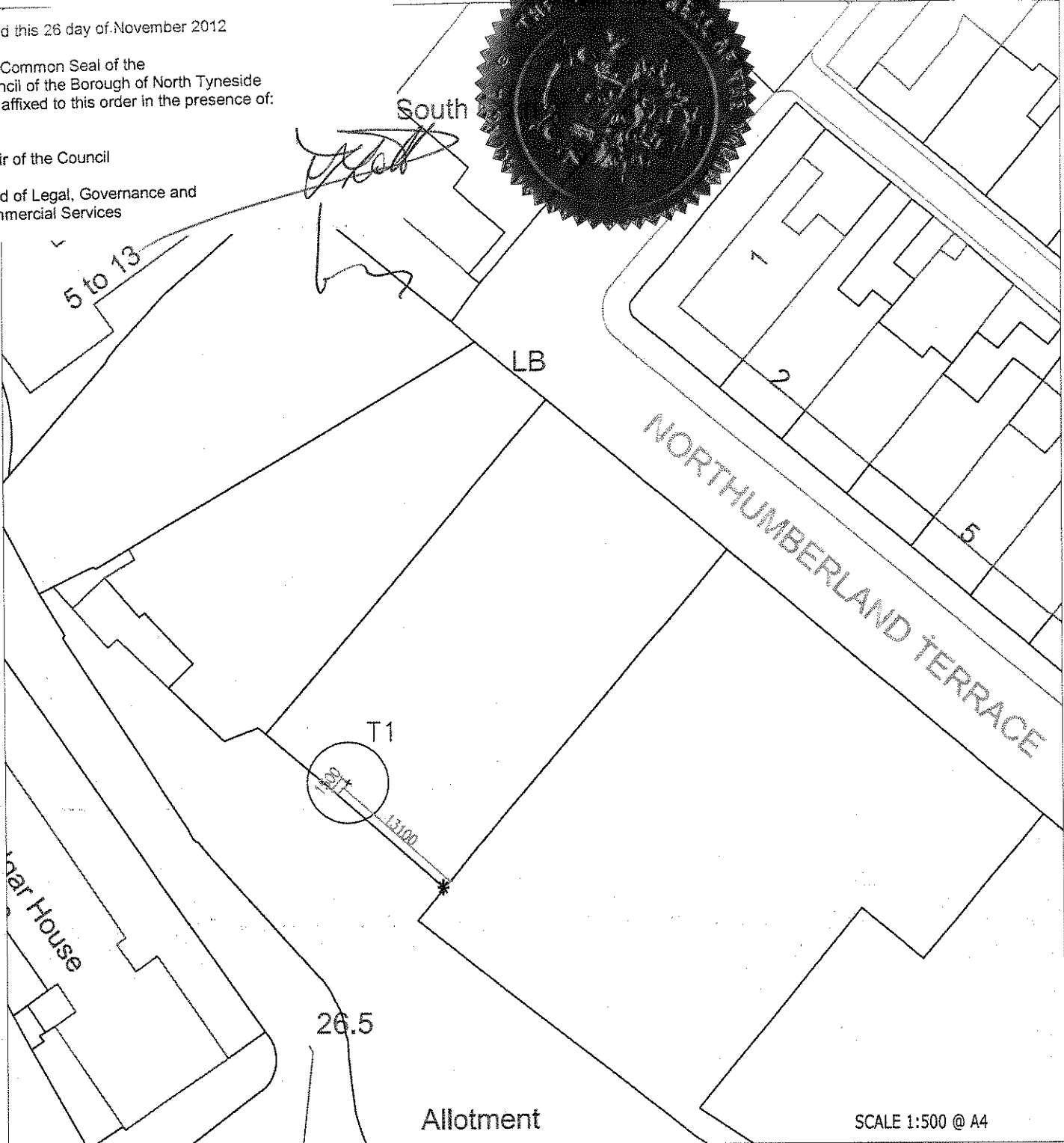

Allotment

SCALE 1:500 @ A4

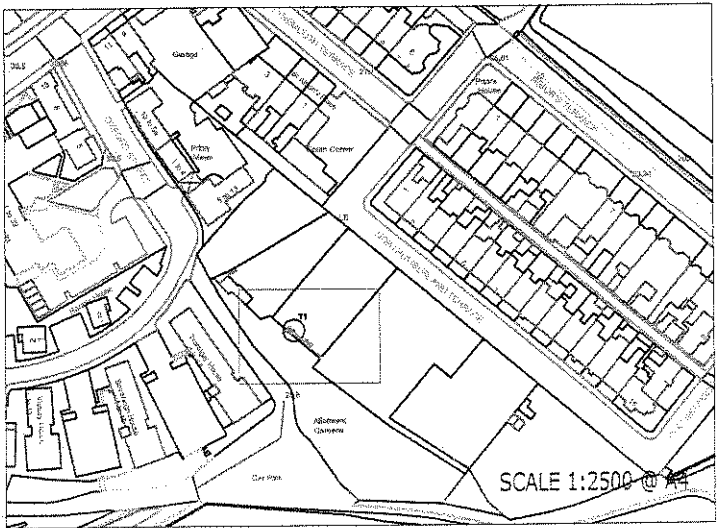

SCALE 1:2500 @ A4

NORTH TYNESIDE COUNCIL ALLOTMENT GARDENS SOUTH WEST OF 5 NORTHUMBERLAND TERRACE, TYNEMOUTH TREE PRESERVATION ORDER 2012

Ken Wilson
Head of Regeneration,
Development and Regulatory
Services
Quadrant East
The Silverlink
Cobalt Business Park
North Tyneside
NE27 0BY

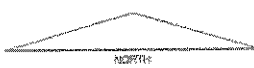

Scale: 1:500 @ A4

This map is based upon Ordnance Survey material with the permission of Ordnance Survey on behalf of the Controller of Her Majesty's Stationery Office Crown copyright. Unauthorised reproduction infringes Crown copyright and may lead to prosecution or civil proceedings.
North Tyneside Council - 0190016801 - 2012

Town and Country Planning Act 1990
The Council of the Borough of North Tyneside (Allotment Gardens south west of 5
Northumberland Terrace, Tynemouth) Tree Preservation Order 2012

CONFIRMATION OF ORDER

This Order was confirmed by the Council of the Borough of North Tyneside without modification on the 10 day of January 2013.

The Common Seal of the Council of the Borough of North Tyneside was affixed to this order in the presence of:

James Hunter

Chair of the Council

J. Meek
(Authorised Signatory)

Head of Legal, Governance and
Commercial Services

