

TOWN AND COUNTRY PLANNING (TREES) REGULATIONS 1999
As amended by the Town and Country Planning
(Trees)(Amendment)(England) Regulations 2008

Town and Country Planning Act 1990
The (Holywell Grange, East Holywell) Tree Preservation Order 2011

The Council of the Borough of North Tyneside, in exercise of the powers conferred on them by sections 198 [,201] and 203 of the Town and Country Planning Act 1990 hereby make the following Order—

Citation

1. This Order may be cited as the (Holywell Grange, East Holywell) Tree Preservation Order 2011

Interpretation

2. In this Order “the authority” means the Council of the Borough of North Tyneside and unless the context otherwise requires, any reference in this Order to a numbered section is a reference to the section so numbered in the Town and Country Planning Act 1990.

[Application of section 201

3. The authority hereby direct that section 201 (provisional tree preservation orders) shall apply to this Order and, accordingly, this Order shall take effect provisionally on 18th October 2011]

Prohibited acts in relation to trees

4. Without prejudice to subsections (6) and (7) of section 198 (power to make tree preservation orders) or subsection (1) of section 200 (tree preservation orders: Forestry Commissioners), and subject to article 5, no person shall—

- (a) cut down, top, lop, uproot, wilfully damage or wilfully destroy; or
- (b) cause or permit the cutting down, topping, lopping, uprooting, wilful damage or wilful destruction of,

any tree specified in Schedule 1 to this Order or comprised in a group of trees or in a woodland so specified, except with the consent of the authority and, where such consent is given subject to conditions, in accordance with those conditions.

Exemptions

5.—(1) Nothing in article 4 shall prevent—

- (a) the cutting down, topping, lopping or uprooting of a tree by or at the request of a statutory undertaker, where the land on which the tree is situated is operational land of the statutory undertaker and the work is necessary—
 - (i) in the interests of the safe operation of the undertaking;

- (ii) in connection with the inspection, repair or renewal of any sewers, mains, pipes, cables or other apparatus of the statutory undertaker; or
 - (iii) to enable the statutory undertaker to carry out development permitted by or under the Town and Country Planning (General Permitted Development) Order 1995;
- (aa) the cutting down, topping, lopping or uprooting of a tree where that work is required to enable the implementation of an order made or confirmed under paragraph 8(1) or paragraph 15(1) of Schedule 1 to the Highways Act 1980 (procedures for making or confirming certain orders and schemes);
 - (ab) the cutting down, topping, lopping or uprooting of a tree where that work is urgently necessary for national security purposes;
 - (b) the cutting down, topping, lopping or uprooting of a tree cultivated for the production of fruit in the course of a business or trade where such work is in the interests of that business or trade;
 - (c) the pruning, in accordance with good horticultural practice, of any tree cultivated for the production of fruit;
 - (d) the cutting down, topping, lopping or uprooting of a tree where that work is required to enable a person to implement a planning permission (other than an outline planning permission or, without prejudice to paragraph (a)(iii), a permission granted by or under the Town and Country Planning (General Permitted Development) Order 1995) granted on an application under Part III of the Act, or deemed to have been granted (whether for the purposes of that Part or otherwise);
 - (e) the cutting down, topping, lopping or uprooting of a tree by or at the request of the Environment Agency to enable the Agency to carry out development permitted by or under the Town and Country Planning (General Permitted Development Order) 1995;
 - (f) the cutting down, topping, lopping or uprooting of a tree by or at the request of a drainage body where that tree interferes, or is likely to interfere, with the exercise of any of the functions of that body in relation to the maintenance, improvement or construction of watercourses or of drainage works, and for this purpose “drainage body” and “drainage” have the same meanings as in the Land Drainage Act 1991; or
 - (g) without prejudice to section 198(6)(b), the felling or lopping of a tree or the cutting back of its roots by or at the request of, or in accordance with a notice served by, a licence holder under paragraph 9 of Schedule 4 to the Electricity Act 1989.

(2) In paragraph (1), “statutory undertaker” means any of the following—

- a person authorised by any enactment to carry on any railway, light railway, tramway, road transport, water transport, canal, inland navigation, dock, harbour, pier or lighthouse undertaking, or any undertaking for the supply of hydraulic power,
- a relevant airport operator (within the meaning of Part V of the Airports Act 1986),
- the holder of a licence under section 6 of the Electricity Act 1989,
- a public gas transporter,
- the holder of a licence under section 7 of the Telecommunications Act 1984 to whom the telecommunications code (within the meaning of that Act) is applied,
- a water or sewerage undertaker,
- the Civil Aviation Authority or a body acting on behalf of that Authority,
- the Post Office.

Application of provisions of the Town and Country Planning Act 1990

7.—(1) The provisions of the Town and Country Planning Act 1990 relating to registers, applications, permissions and appeals mentioned in column (1) of Part I of Schedule 2 to this Order shall have effect, in relation to consents under this Order and applications for such consent, subject to the adaptations and modifications mentioned in column (2).

(2) The provisions referred to in paragraph (1), as so adapted and modified, are set out in Part II of that Schedule.

Directions as to replanting

8.—(1) Where consent is granted under this Order for the felling in the course of forestry operations of any part of a woodland area, the authority may give to the owner of the land on which that part is situated (“the relevant land”) a direction in writing specifying the manner in which and the time within which he shall replant the relevant land.

(2) Where a direction is given under paragraph (1) and trees on the relevant land are felled (pursuant to the consent), the owner of that land shall replant it in accordance with the direction.

(3) A direction under paragraph (1) may include requirements as to—

- (a) species;
- (b) number of trees per hectare;
- (c) the preparation of the relevant land prior to the replanting; and

- (d) the erection of fencing necessary for the protection of the newly planted trees.

Compensation

9.—(1) If, on a claim under this article, a person establishes that loss or damage has been caused or incurred in consequence of—

- (a) the refusal of any consent required under this Order; or
- (b) the grant of any such consent subject to conditions,

he shall, subject to paragraphs (3) and (4), be entitled to compensation from the authority.

(2) No claim, other than a claim made under paragraph (3), may be made under this article—

- (a) if more than 12 months has elapsed since the date of the authority's decision or, where such a decision is the subject of an appeal to the Secretary of State, the date of the final determination of the appeal; or
- (b) if the amount in respect of which the claim would otherwise have been made is less than £500.

(3) Where the authority refuse consent under this Order for the felling in the course of forestry operations of any part of a woodland area, they shall not be required to pay compensation to any person other than the owner of the land; and such compensation shall be limited to an amount equal to any depreciation in the value of the trees which is attributable to deterioration in the quality of the timber in consequence of the refusal.

(4) In any other case, no compensation shall be payable to a person—

- (a) for loss of development value or other diminution in the value of the land;
- (b) for loss or damage which, having regard to the application and the documents and particulars accompanying it, was not reasonably foreseeable when consent was refused or was granted subject to conditions;
- (c) for loss or damage reasonably foreseeable by that person and attributable to his failure to take reasonable steps to avert the loss or damage or to mitigate its extent; or
- (d) for costs incurred in appealing to the Secretary of State against the refusal of any consent required under this Order or the grant of any such consent subject to conditions.

(5) Subsections (3) to (5) of section 11 (terms of compensation on refusal of licence) of the Forestry Act 1967 shall apply to the assessment of compensation under paragraph (3) as it applies to the assessment of

compensation where a felling licence is refused under section 10 (application for felling licence and decision of Commissioners thereon) of that Act as if for any reference to a felling licence there were substituted a reference to a consent required under this Order and for the reference to the Commissioners there were substituted a reference to the authority.

(6) In this article—

“development value” means an increase in value attributable to the prospect of development; and, in relation to any land, the development of it shall include the clearing of it; and

“owner” has the meaning given to it by section 34 of the Forestry Act 1967.

TREE PRESERVATION ORDER 2011

HOLYWELL GRANGE, EAST HOLYWELL

FIRST SCHEDULE

The map referred to is at a scale of 1:500 and is based on an enlargement of the 1:1250 O.S. edition of sheet number's NZ3173.

The area covered by the Order is the curtilage of Holywell Grange and Holywell Grange Farm, East Holywell, NE27 0JJ.

The area is wholly within the Metropolitan Borough of North Tyneside in the County of Tyne and Wear.

TREES SPECIFIED INDIVIDUALLY

(Encircled in black on the map)

No. on Map	Description	Situation
		The following trees are measured from a point at the north western corner of Holywell Grange [Marked A*] offset west. All dimensions are to the centre of the tree.
T1	Sycamore	48.7 metres west; offset 25.5 metres in a southerly direction.
T2	Sycamore	53.2 metres west; offset 22.2 metres in a southerly direction.
T3	Sycamore	53.2 metres west; offset 19.0 metres in a southerly direction.
T4	Sycamore	53.8 metres west; offset 15.8 metres in a southerly direction.
T5	Sycamore	54.3 metres west; offset 13.2 metres in a southerly direction.
T6	Sycamore	54.8 metres west; offset 10.3 metres in a southerly direction.
T7	Sycamore	55.9 metres west; offset 4.2 metres in a southerly direction.
T8	Sycamore	56.1 metres west; offset .8 metres in a southerly direction.
T9	Sycamore	56.7 metres west; offset 2.3 metres in a northerly direction.

T10	Sycamore	55.0 metres west; offset 3.7 metres in a northerly direction.
T11	Sycamore	48.8 metres west; offset 4.1 metres in a northerly direction.
T12	Sycamore	47.0 metres west; offset 1.0 metres in a northerly direction.
T13	Poplar	58.8 metres west; offset 12.2 metres in a northerly direction.
T14	Sycamore	58.7 metres west; offset 14.5 metres in a northerly direction.
T15	Sycamore	58.7 metres west; offset 18.2 metres in a northerly direction.
T16	Sycamore	59.0 metres west; offset 19.4 metres in a northerly direction.
T17	Sycamore	59.6 metres west; offset 25.1 metres in a northerly direction.
T18	Ash	56.3 metres west; offset 41.8 metres in a northerly direction.
T19	Sycamore	63.7 metres west; offset 43.6 metres in a northerly direction.
T20	Sycamore	63.2 metres west; offset 46.0 metres in a northerly direction.
T21	Sycamore	65.1 metres west; offset 49.3 metres in a northerly direction.
T22	Sycamore	61.8 metres west; offset 48.8 metres in a northerly direction.
T23	Sycamore	59.3 metres west; offset 47.3 metres in a northerly direction.
T24	Sycamore	52.3 metres west; offset 46.7 metres in a northerly direction.
T25	Sycamore	54.2 metres west; offset 49.4 metres in a northerly direction.
T26	Sycamore	50.1 metres west; offset 49.5 metres in a northerly direction.
T27	Sycamore	46.8 metres west; offset 49.4 metres in a northerly direction.

T28	Poplar	45.0 metres west; offset 47.7 metres in a northerly direction.
T29	Sycamore	43.5 metres west; offset 49.4 metres in a northerly direction.
T30	Sycamore	39.1 metres west; offset 49.2 metres in a northerly direction.
T31	Sycamore	35.7 metres west; offset 49.3 metres in a northerly direction.
T32	Sycamore	32.2 metres west; offset 49.2 metres in a northerly direction.
T33	Sycamore	28.4 metres west; offset 49.5 metres in a northerly direction.
T34	Sycamore	24.3 metres west; offset 49.3 metres in a northerly direction.
T35	Sycamore	21.2 metres west; offset 49.6 metres in a northerly direction.
T36	Ash	25.6 metres west; offset 44.2 metres in a northerly direction.
T37	Sycamore	20.9 metres west; offset 39.0 metres in a northerly direction.
T38	Sycamore	20.4 metres west; offset 33.2 metres in a northerly direction.
T39	Sycamore	24.8 metres west; offset 2.8 metres in a northerly direction.
T40	Oak	21.7 metres west; offset 4.2 metres in a northerly direction.
T41	Sycamore	19.3 metres west; offset 2.7 metres in a southerly direction.
T42	Ash	14.6 metres west; offset .2 metres in a southerly direction.
T43	Sycamore	9.9 metres west; offset 27.3 metres in a southerly direction.
T44	Beech	12.7 metres west; offset 21.4 metres in a southerly direction.
T45	Beech	9.9 metres west; offset 18.7 metres in a southerly direction.

T46	Sycamore	6.2 metres west; offset 14.0 metres in a southerly direction.
T47	Beech	7.0 metres west; offset 6.5 metres in a southerly direction.
T48	Beech	2.2 metres west; offset 3.8 metres in a southerly direction.

The following trees are measured from a point at the north western corner of Holywell Grange [Marked A*] offset north.

T49	Sycamore	0.3 metres north; offset 0.1 metres in a westerly direction.
T50	Oak	9.4 metres north; offset .5 metres in a westerly direction.
T51	Beech	15.2 metres north; offset 2.7 metres in a westerly direction.
T52	Beech	19.1 metres north; offset 2.7 metres in a westerly direction.
T53	Beech	21.4 metres north; offset .4 metres in a easterly direction.
T54	Sycamore	23.9 metres north; offset 2.1 metres in a westerly direction.
T55	Sycamore	26.5 metres north; offset 0 metres in a westerly direction.
T56	Sycamore	36.4 metres north; offset 2.7 metres in a easterly direction.
T57	Sycamore	49.4 metres north; offset 5.5 metres in a easterly direction.

The following trees are measured from a point at the south western corner of the northern most barn in Holywell Grange Farm [Marked B*] offset west.

T58	Sycamore	8.7 metres west; offset 8.7 metres in a northerly direction.
T59	Tulip Tree	7.3 metres west; offset 5.4 metres in a northerly direction.

The following trees are measured from a point at the north eastern corner of the northern most barn on Holywell Grange Farm [Marked C*] offset east.

T60	Sycamore	10.8 metres east; offset 1.5 metres in a southerly direction.
T61	Sycamore	8.7 metres east; offset 5.8 metres in a northerly direction.

TREES SPECIFIED BY REFERENCE TO AN AREA

(Within a dotted black line on the map)

NONE

GROUPS OF TREES

(Within a broken black line on the map)

NONE

WOODLANDS

NONE

SECOND SCHEDULE

PART I PROVISIONS OF THE TOWN AND COUNTRY PLANNING ACT 1990 APPLIED WITH ADAPTATIONS OR MODIFICATIONS

Provision of the Town and Country Planning Act 1990	Adaptation or Modification
Section 69 (registers)	<p>(a) In subsection (1)—</p> <p style="margin-left: 40px;">(i) omit—</p> <p style="margin-left: 80px;">“, in such manner as may be prescribed by a development order,”,</p> <p style="margin-left: 80px;">“such” in the second place where it appears, and</p> <p style="margin-left: 80px;">“as may be so prescribed”; and</p> <p style="margin-left: 40px;">(ii) substitute “matters relevant to tree preservation orders made by the authority” for “applications for planning permission”.</p> <p>(b) In subsection (2)—</p> <p style="margin-left: 40px;">(i) after “contain” insert “, as regards each such order”; and</p> <p style="margin-left: 40px;">(ii) for paragraphs (a) and (b) substitute—</p> <p style="margin-left: 80px;">(a) details of every application under the order and of the authority’s decision (if any) in relation to each such application, and</p> <p style="margin-left: 80px;">(b) a statement as to the subject-matter of every appeal under the order and of the date and nature of the Secretary of State’s determination of it.”.</p> <p>(c) Omit subsections (3) and (4) (as required by section 198(4)).</p>
Section 70 (determination of applications: general considerations)	<p>(a) In subsection (1)—</p> <p style="margin-left: 40px;">(i) substitute—</p> <p style="margin-left: 80px;">“Subject to subsections (1A) and (1B), where”</p>

	<p>for “Where”;</p> <p>“the authority” for “a local planning authority”;</p> <p>“consent under a tree preservation order” for “planning permission” where those words first appear; and</p> <p>“consent under the order” for “planning permission” in both of the other places where those words appear;</p> <p>(ii) after “think fit”, insert—</p> <p>“(including conditions limiting the duration of the consent or requiring the replacement of trees)”;</p> <p>(iii) omit “subject to sections 91 and 92,”.</p> <p>(b) After subsection (1) insert—</p> <p>“(1A) Where an application relates to an area of woodland, the authority shall grant consent so far as accords with the practice of good forestry, unless they are satisfied that the granting of consent would fail to secure the maintenance of the special character of the woodland or the woodland character of the area.</p> <p>(1B) Where the authority grant consent for the felling of trees in a woodland area they shall not impose conditions requiring replacement where such felling is carried out in the course of forestry operations (but may give directions for securing replanting).”.</p> <p>(c) Omit subsections (2) and (3).</p>
<p>Section 75 (effect of planning permission)</p>	<p>(a) In subsection (1) substitute—</p> <p>(i) “Any” for the words from “Without” to “any”;</p> <p>(ii) “consent under a tree preservation order” for “planning permission to develop land”;</p> <p>(iii) “the consent” for “the permission”; and</p> <p>(iv) “the land to which the order relates” for “the land”.</p> <p>(b) Omit subsections (2) and (3).</p>

Section 78 (right to appeal against planning decisions and failure to take such decisions)

(a) In subsection (1) substitute—

- (i) “the authority” for “a local planning authority”;
- (ii) “consent under a tree preservation order” for “planning permission” in the first place where those words appear;
- (iii) “consent under such an order” for “planning permission” in the second place where those words appear;
- (iv) for paragraph (c) substitute—
 - “(c) give a direction under a tree preservation order, or refuse an application for any consent, agreement or approval of that authority required by such a direction; or
 - (d) fail to determine any such application as is referred to in paragraphs (a) to (c) within the period of 8 weeks beginning with the date on which the application was received by the authority.”.

(b) Omit subsection (2).

(c) In subsection (3) for “served within such time and in such manner as may be prescribed by a development order.” substitute—

“in writing addressed to the Secretary of State, specifying the grounds on which the appeal is made; and such notice shall be served—

- (a) in respect of a matter mentioned in any of paragraphs (a) to (c) of subsection (1), within the period of 28 days from the receipt of notification of the authority’s decision or direction or within such longer period as the Secretary of State may allow;
- (b) in respect of such a failure as is mentioned in paragraph (d) of that subsection, at any time after the expiration of the period mentioned in that paragraph, but if the authority have informed the applicant that the application has been refused, or granted subject to conditions, before an appeal has been made, an appeal may only be made against that refusal or grant.”.

	<p>(d) For subsection (4), substitute—</p> <p>“(4) The appellant shall serve on the authority a copy of the notice mentioned in subsection (3).”.</p> <p>(e) For subsection (5), substitute—</p> <p>“(5) For the purposes of the application of section 79(1), in relation to an appeal made under subsection (1)(d), it shall be assumed that the authority decided to refuse the application in question.”.</p>
<p>Section 79 (determination of appeals)</p>	<p>(a) In subsections (1) and (2), substitute “the authority” for “the local planning authority”.</p> <p>(b) Omit subsection (3).</p> <p>(c) In subsection (4), substitute—</p> <ul style="list-style-type: none"> (i) “section 70(1), (1A) and (1B)” for “sections 70, 72(1) and (5), 73 and 73A and Part I of Schedule 5”; (ii) “consent under a tree preservation order” for “planning permission”; and (iii) “the authority” for “the local planning authority and a development order may apply, with or without modifications, to such an appeal any requirements imposed by a development order by virtue of sections 65 or 71.”. <p>(d) Omit subsections (6) and (6A).</p> <p>(e) In subsection (7), omit the words after “section 78”.</p>

PART II
PROVISIONS OF THE TOWN AND COUNTRY PLANNING ACT 1990,
AS ADAPTED AND MODIFIED BY PART I

The following provisions of the Town and Country Planning Act 1990, as adapted and modified by Part I of this Schedule, apply in relation to consents, and applications for consent, under this Order.

Section 69

(1) Every local planning authority shall keep a register containing information with respect to matters relevant to tree preservation orders made by the authority.

(2) The register shall contain, as regards each such order—

- (a) details of every application under the order and of the authority's decision (if any) in relation to each such application, and
- (b) a statement as to the subject-matter of every appeal under the order and of the date and nature of the Secretary of State's determination of it.

.....

(5) Every register kept under this section shall be available for inspection by the public at all reasonable hours.

Section 70

(1) Subject to subsections (1A) and (1B), where an application is made to the authority for consent under a tree preservation order—

- (a) they may grant consent under the order, either unconditionally or subject to such conditions as they think fit (including conditions limiting the duration of the consent or requiring the replacement of trees); or
- (b) they may refuse consent under the order.

(1A) Where an application relates to an area of woodland, the authority shall grant consent so far as accords with the practice of good forestry, unless they are satisfied that the granting of consent would fail to secure the maintenance of the special character of the woodland or the woodland character of the area.

(1B) Where the authority grant consent for the felling of trees in a woodland area they shall not impose conditions requiring replacement where such felling is carried out in the course of forestry operations (but may give directions for securing replanting).

.....

Section 75

Any grant of consent under a tree preservation order shall (except in so far as the consent otherwise provides) enure for the benefit of the land to which the order relates and of all persons for the time being interested in it.

Section 78

(1) Where the authority—

- (a) refuse an application for consent under a tree preservation order or grant it subject to conditions;
- (b) refuse an application for any consent, agreement or approval of that authority required by a condition imposed on a grant of consent under such an order or grant it subject to conditions;
- (c) give a direction under a tree preservation order, or refuse an application for any consent, agreement or approval of that authority required by such a direction; or
- (d) fail to determine any such application as is referred to in paragraphs (a) to (c) within the period of 8 weeks beginning with the date on which the application was received by the authority,

the applicant may by notice appeal to the Secretary of State.

.....

(3) Any appeal under this section shall be made by notice in writing addressed to the Secretary of State, specifying the grounds on which the appeal is made; and such notice shall be served—

- (a) in respect of a matter mentioned in any of paragraphs (a) to (c) of subsection (1), within the period of 28 days from the receipt of notification of the authority's decision or direction or within such longer period as the Secretary of State may allow;
- (b) in respect of such a failure as is mentioned in paragraph (d) of that subsection, at any time after the expiration of the period mentioned in that paragraph, but if the authority have informed the applicant that the application has been refused, or granted subject to conditions, before an appeal has been made, an appeal may only be made against that refusal or grant.

(4) The appellant shall serve on the authority a copy of the notice mentioned in subsection (3).

(5) For the purposes of the application of section 79(1), in relation to an appeal made under subsection (1)(d), it shall be assumed that the authority decided to refuse the application in question.

.....

Section 79

(1) On an appeal under section 78 the Secretary of State may—

- (a) allow or dismiss the appeal, or
- (b) reverse or vary any part of the decision of the authority (whether the appeal relates to that part of it or not),

and may deal with the application as if it had been made to him in the first instance.

(2) Before determining an appeal under section 78 the Secretary of State shall, if either the appellant or the authority so wish, give each of them an opportunity of appearing before and being heard by a person appointed by the Secretary of State for the purpose.

.....

(4) Subject to subsection (2), the provisions of section 70(1), (1A) and (1B) shall apply, with any necessary modifications, in relation to an appeal to the Secretary of State under section 78 as they apply in relation to an application for consent under a tree preservation order which falls to be determined by the authority.

(5) The decision of the Secretary of State on such an appeal shall be final.

.....

(7) Schedule 6 applies to appeals under section 78.

THE COMMON SEAL of the)
COUNCIL OF THE BOROUGH OF)
NORTH TYNESIDE was hereunto)
affixed this 13th day of October 2011)
in the presence of:)

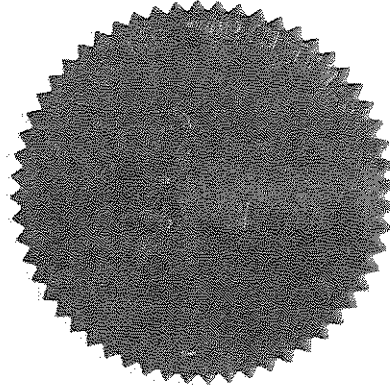

J. Stirling
Chair of the Council

HM Coombs
Head of Legal, Governance and
Commercial Services

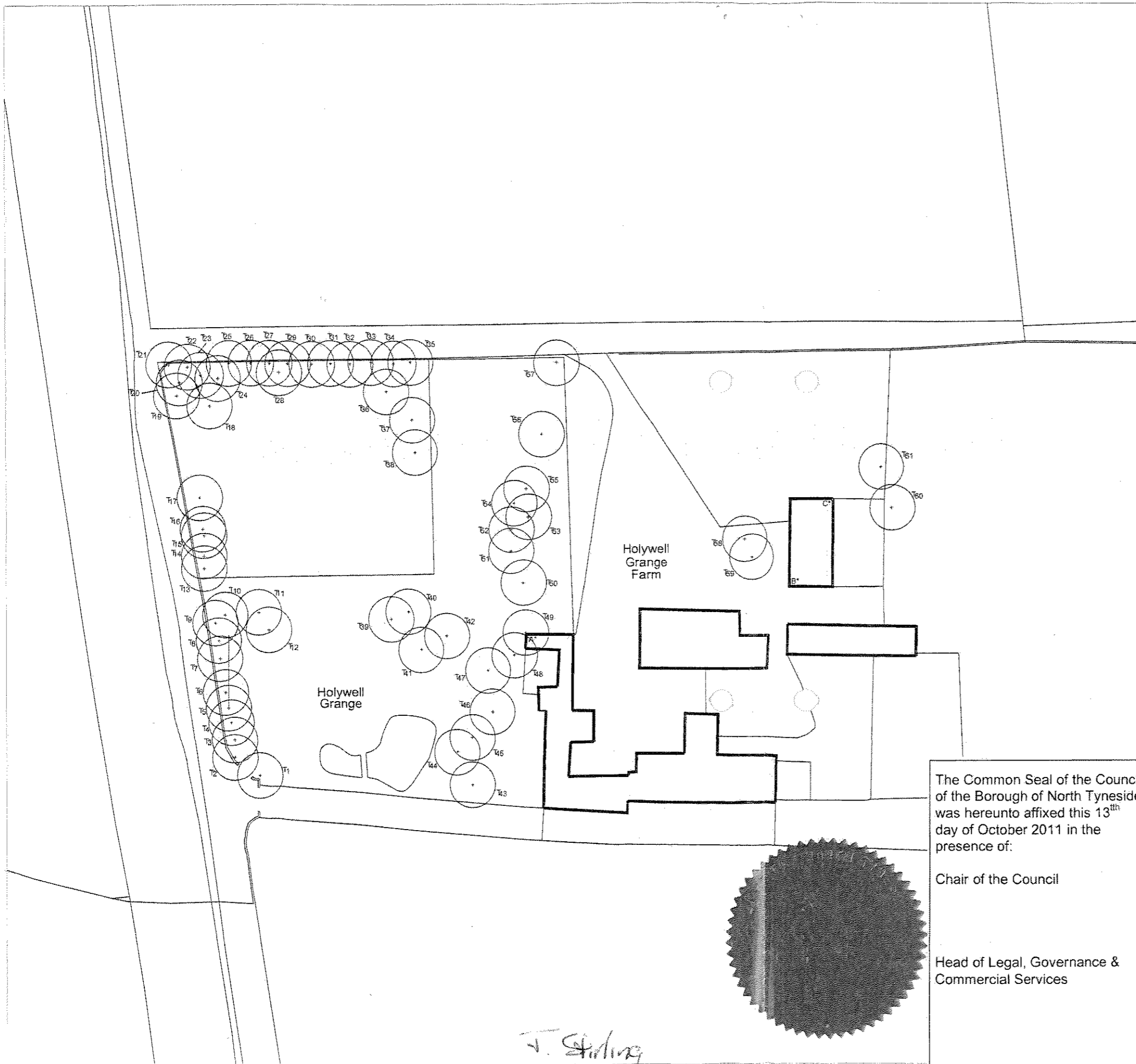

J. Stirling
HM Coombs



LOCATION PLAN 1:1000

NORTH TYNESIDE COUNCIL
 Holywell Grange, East Holywell
 Tyne and Wear
TREE PRESERVATION ORDER 2011

Peter Brown
 Planning Manager
 North Tyneside Council
 Quadrant
 The Silverlink North
 Colbalt Business Park
 North Tyneside
 NE27 0BY



Scale 1:500 @ A2

This map is based upon Ordnance Survey material with the permission of Ordnance Survey on behalf of the Controller of Her Majesty's Stationery Office Crown copyright. Unauthorised reproduction infringes Crown copyright and may lead to prosecution or civil proceedings.
 North Tyneside Council - 100016801 - 2011

The Common Seal of the Council of the Borough of North Tyneside was hereunto affixed this 13th day of October 2011 in the presence of:

Chair of the Council

Head of Legal, Governance & Commercial Services